

使 用 說 明 書

MODEL NO: MR-ES70
MR-ES90

◎ Warning	P1
◎ Installation	P2
◎ Mounting method	P3
◎ Keyboard operation	P4
◎ Maintenance & Cleaning	P5
◎ Service parts identification 機型各部位名稱	P6
◎ Specifications 性能規格表	P7
◎ Wiring diagram 線路圖	P7
◎ 注意事項	P1
◎ 安裝守則	P2
◎ 安裝方法	P3
◎ 功能及操作說明	P4
◎ 清洗方法說明	P5

香港沙田大圍成運道21-23號

群力工業大廈2樓1室

UNIT 1,2/F., KINGLET IND.BUILDING

21-23 SHING WAN ROAD, SHATIN, HONG KONG

TEL:2604-9777 FAX:2607-3165

[Http://www.dongwoo-hk.com](http://www.dongwoo-hk.com)

331-01-000182(2)



東 宇 實 業 有 限 公 司
Dong Woo Industrial Co.,Ltd.

注意事項

重要說明

為安全起見，初次使用產品前請先細閱本說明書，並保存本說明書，以便作參考之用。
本產品只供家居使用，請必須依照本說明書內的指示安裝及操作。

***安裝前請先撕除抽油煙機機箱外的保護膠膜。

1. 請依照本說明書內的指示安裝及操作。
2. 維修抽油煙機前，請務必切斷電源。
3. 維修抽油煙機時，請戴上橡膠手套。
4. 請勿直接噴水在抽油煙機上。
5. 當與易燃氣體一起使用時，廚房請保持良好的通風，以避免危險。
6. 不可在抽油煙機下方直接燃燒。
7. 請勿與其他易燃氣體共用排氣通道。
8. 孩童不可玩耍此抽油煙機。且不可在無人監督下操作此抽油煙機。
9. 若未依此說明書執行清潔可能產生危險或引起火災。
10. 不可在抽油煙機下方點燃酒精等易燃物品。
11. 警告：在煮食過程中，部份零配件有可能會變燙。
12. 排出的油煙不得藉由瓦斯或其他燃料之排氣通道釋出。
13. 排出的油煙程序需符合相關的排放空氣法規。
14. 若電源線損毀，請勿操作抽油煙機。必須由製造廠或總代理維修部派遣師傅或有類似資歷的認可技術人員更換以避免危險。
15. 不可使用此抽油煙機的人：生理、感官或心智能力不足（包括兒童），或缺乏相關經驗和知識。除非他們是在被監督或有其他具相關訓練的人員指導下方可使用。
16. 清潔、維修抽油煙機或更換燈膽前或卸下抽油煙機煙罩底板前請切斷電源。
17. 此抽油煙機需安裝於煮食爐上方65-75公分處。
18. 此抽油煙機必須接地。
19. 為避免抽油煙機油污殘留產生危險或引起火災，請經常性清洗或每個月至少清洗兩次保護網、扇葉和其他容易積油的零配件。

安裝守則

- 包裝材料〈如：塑膠袋、發泡膠等〉有潛在性的危險請勿讓孩童接觸。
- 請由受過專業訓練的技術人員進行安裝。
- 安裝前請確認規格線路標籤上所列示的電壓符合您家的電壓。
- 安裝燈膽後接上電源，檢查照明、摩打及開關是否正常。
- 安裝前檢查下列附件：

說明書、小油杯二個、風管圈、長油杯二個、螺絲包1組〈M6 x 1 1/2 木螺釘4支、華司4片、3/16 x 1 華司頭螺絲4支、M4 x 8傘頭2種牙螺絲2支〉。

(一) 周圍環境(圖一)

排油煙機安裝位置，如在窗上或附近有太多門窗，請在開動排油煙機前，先關閉門窗，以免空氣對流大而影響吸力，因當油煙上升未至25公分之有效吸力範圍，則無法充分發揮排油煙機效果。

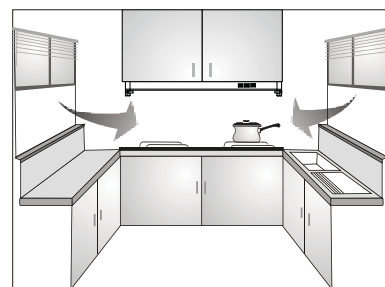

門窗太多 空氣對流太大 (圖一)

(二) 安裝高度(圖二)

排油煙機安裝高度，自本機底板至瓦斯爐面之距離以 70 ± 5 公分為最理想。

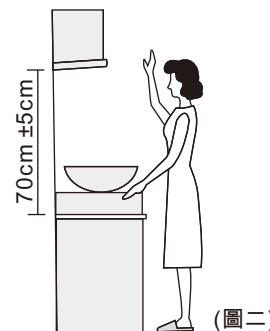

(圖二)

(三) 機體應保持水平(圖三)

機體應保持前、後、左、右水平，以免氣流箱，導油盆積油而溢出。左、右水平可由掛碼調整，前、後水平則由鋼釘螺絲鎖緊牆壁以固定標準。

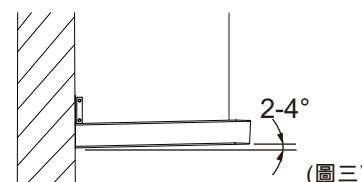

(圖三)

(四) 主機體安裝

注意：未受過專業訓練者請勿自行安裝，除非有專業人員在旁指導或介紹過如何安裝且願意自行負責一切後果。孩子應該被監督且保證他們不玩這項裝置。

1. 在已選定位置上，鑽好牆孔，先上螺絲。
2. 將機背之掛碼螺絲旋鬆拉高，將油機掛在牆壁螺絲上。
※吊掛飾板需鎖緊在牆壁上，以避免發生意外。
3. 調整好左右水平後，即將掛碼螺絲旋緊固定機身。
※機身應保持水平，不可傾斜裝設於牆壁。
4. 按機身之出風管接頭之直徑裝上適合之排風管通出屋外。
※屋外風管應長約1英呎，向下彎45度避免受風雨影響。



(五) 排風管

排風管必須配合本機出風管接頭之直徑(6吋)及盡量避免太多彎位。

安裝方法

櫥櫃開口尺寸

內置式抽油煙機是設計安裝於櫥櫃內。下列開口尺寸為側吊掛用。

平櫥櫃身安裝尺寸 / * 平櫥櫃門板安裝尺寸

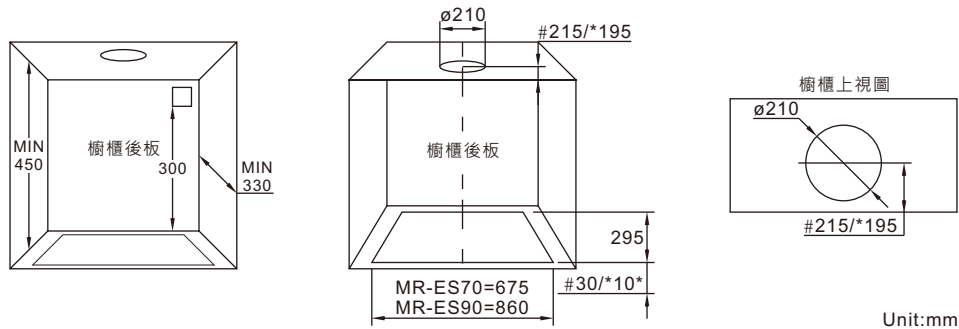

I. 側吊掛

1. 卸除底部面板：請旋鬆安全螺絲，易拆開關旋鈕依逆時針方向轉為 " — "。
2. 將油槽取下。
3. 將油煙機置入廚櫃中。
4. 使用 4根6#1 1/2" 木螺絲和 4根5 x 12 x 1T 華司螺絲固定在廚櫃兩側。將螺絲鎖緊並確認油煙機牢固且不會移動。
5. 底部面板的安全螺絲旋緊，易拆開關旋鈕依順時針旋轉為 " | " 並將油杯裝回。

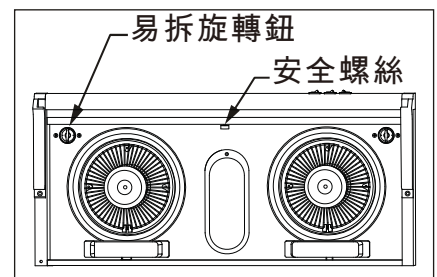

II. 上吊掛

1. 依據右方圖片在櫥櫃木板進行開口。
- 4個Ø8孔是用於上吊掛、2個Ø15是用於取下前方罩板(維修線路時需取下)、1個Ø210是用於安裝風管圈。

平櫥櫃身安裝尺寸 / * 平櫥櫃門板安裝尺寸

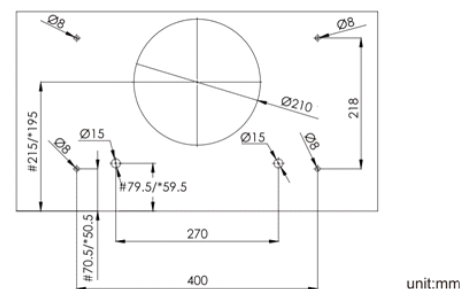

2. 使用四支3/16" x 1" 螺絲，將抽油煙機固定於櫥櫃上。
- 將抽油煙機推至櫥櫃並將各個螺絲鎖緊。
- 注意：請參考右方的油煙機尺寸圖去調整櫥櫃高度。

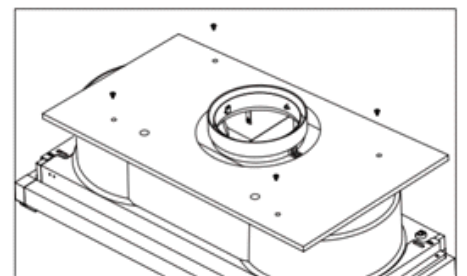

功能及操作說明

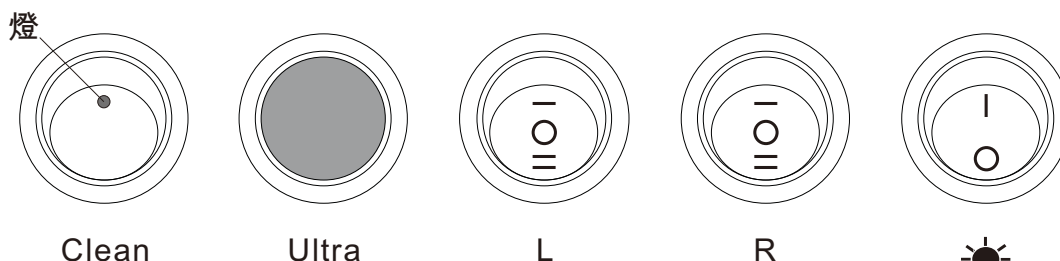

1. Clean鍵功能

- (1) 當左右摩打未運轉狀態下，按壓Clean鍵，Clean燈亮起進入Clean，15分鐘後結束Clean，Clean燈熄滅，同時恢復原來摩打停止狀態。
- (2) 當左右摩打運轉狀態下，按壓Clean鍵，Clean燈亮起而左右摩打會停止運轉，進入Clean，15分鐘後結束，Clean燈熄滅，同時恢復原來摩打運轉狀態。
- (3) 當在Clean狀態下，未到15分鐘要停止此功能，須按壓Clean鍵，Clean燈熄滅立即停止Clean功能。
- (4) 當電熱除油功能進行時，機身會有輕微發熱現象。

2. Ultra鍵功能

- (1) 當左右摩打停止或運轉狀態下，按壓Ultra鍵，其Ultra燈亮起，左右摩打立即停止運轉，同時進入左右摩打高速運轉。
- (2) 當要取消此功能再按壓Ultra鍵，其Ultra燈熄滅則左右摩打恢復原來運轉狀態。

3. "L" 鍵功能

- (1) 按壓"—"左摩打運轉啟動低風速，切換"○"關閉左摩打運轉，切換"="左摩打運轉啟動高風速。

4. "R" 鍵功能

- (1) 按壓"—"右摩打運轉啟動低風速，切換"○"關閉右摩打運轉，切換"="右摩打運轉啟動高風速。

5. 電燈鍵功能

- (1) 按壓"|"開啟電燈，切換"○"則關閉電燈。
- (2) 可獨立切換電燈。

清洗方法說明

1. 清潔前，務必要切斷電源。
2. 定期清潔抽油煙機的內與外，有助延長抽油煙機的使用年期。
3. 使用螺絲批可拆卸風扇保護網的螺絲，取下保護網進行清洗。
完成後，必須重新組裝回原位。
4. 按逆時針方向旋轉可取下保護網的小油盤進行清潔。完成後，
按順時針方向旋轉，即可重新裝回。
5. 抽油煙機的小油盤可拆卸作定期清潔。
6. 在開啟煮食爐前，請先開啟抽油煙機，以免廚房溫度過高。
7. 煙罩兩角有兩個易拎旋鈕，請將旋鈕逆時針拎至 " - " 方位，
即可將煙罩底板卸下，方便進行清潔 / 維修和更換燈膽等。
工作完成後，將煙罩底板蓋上裝回原位，並將左 / 右旋鈕順時
針旋轉至 " | " 鎖上。
8. 更換燈膽前，必需先切斷電源。參考上述第7項步驟將煙罩底
板卸下，再將燈膽旋緊或旋離燈座上。
注意：請使用14W或以下的節能燈膽。而且，燈膽必須附有
國際安全標誌。

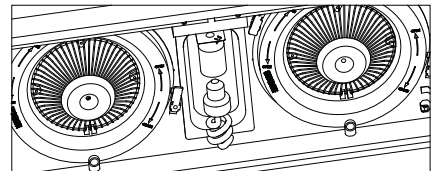
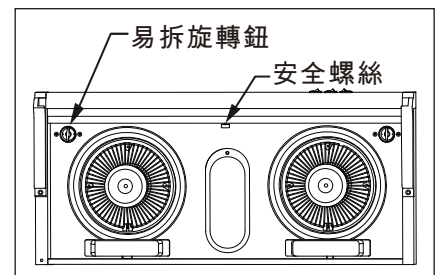
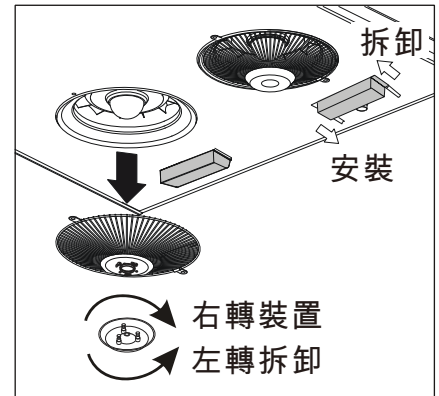
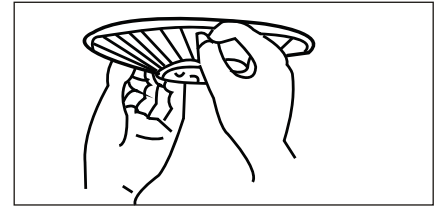

Service parts identification 機箱各部位名稱

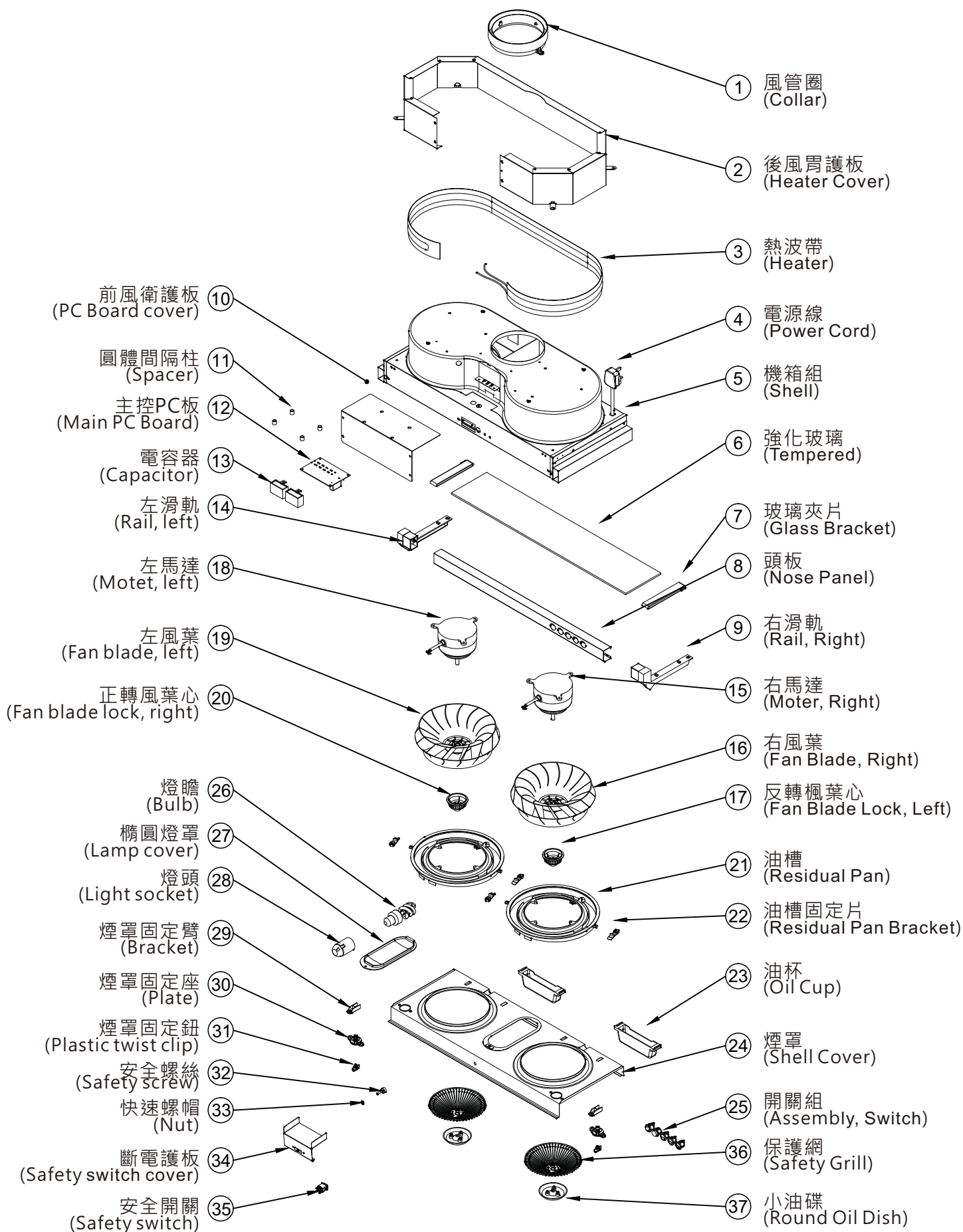

Specifications 性能規格表

電源	VOLTAGE	220V 50Hz	
傳動方式	ROTATING METHOD	雙摩打 Dual-motor	
出風口徑	OUTLET DIAMETER	6"	
照明	ILLUMINATION	14W 省電燈泡 x 1 14W energy saving bulb x 1	
電熱除油	CLEAN	125W	
調速	SPEED	弱 Low	強 High
摩打耗電量	POWER CONSUMED	144W	210W
排風量	AIR EXHAUST	10.8m ³ /min	16.5m ³ /min

Wiring diagram 線路圖

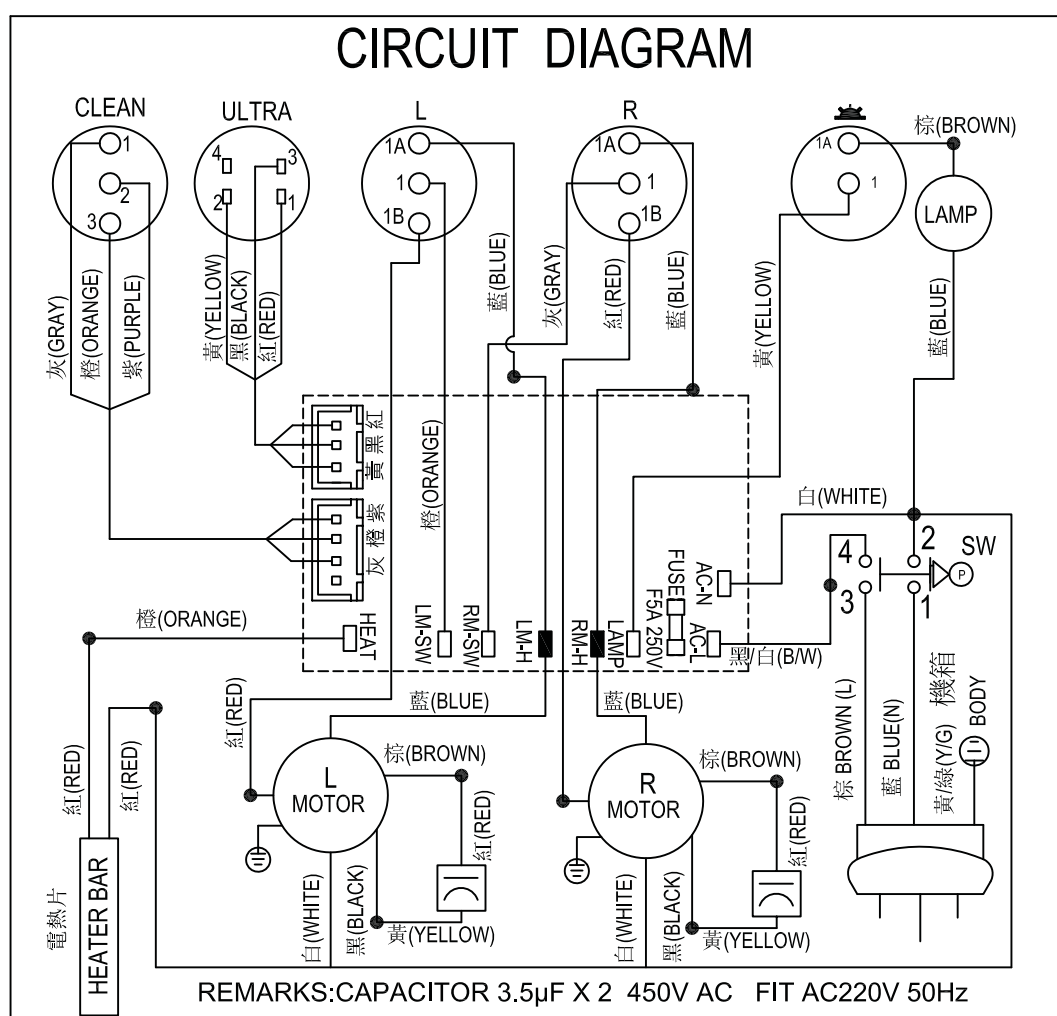

Warning

Important

For safety purpose, you should read the instructions carefully before using the appliance for the first time. Save the instruction for future reference.

The appliance is designed for domestic use and may only be installed and operated in accordance With these instructions for use.

**** Remove the protection film outside the hood before installation.**

1. Please follow the instruction in this user manual.
2. Unplug the power before doing maintenance job on the hood.
3. Wear rubber gloves when doing maintenance job on the hood.
4. Do not spray the hood with water directly.
5. When using the hood with flammable gas, please keep a good air flow in the kitchen to avoid hazard.
6. Do not burn directly under the range hood.
7. Do not share duct with other flammable gas pipes.
8. Children shall not play with the appliance.

Cleaning and user maintenance shall not be made by children without supervision.

9. There is a fire risk if cleaning is not carried out in accordance with the instructions.
10. Do not flambe under the range hood.
11. CAUTION: Accessible parts may become hot when using with cooking appliances.
12. The air must not be discharged into a flue that is used for exhausting fumes from appliances burning gas or other fuels.
13. Regulations concerning the discharge of air have to be fulfilled.
14. If the mains supply cord is damaged, do not operate the appliance, it must be replaced by the manufacturer, its service agent or qualified technicians in order to avoid a hazard.
15. The appliance is not to be used by persons (including children), with reduced physical, sensory or mental capabilities, or lack of experience and knowledge, unless they have been given supervision or instruction.
16. Disconnect the power supply before cleaning, repairing, replacing light bulb or disassembling the hood.
17. The appliance should be positioned 65to75 cm above the cooking range.
18. The hood must be earthed.
19. To prevent fire hazard in case of oil build-up, the turbine impellers and other easily-soiled parts must be cleaned frequently or at least twice a month.

Installation

- Packing materials (plastic bags, polystyrene, etc.) must be kept out of children's reach, as they are potentially dangerous.
- Installation must be carried out by a qualified technician.
- Check the voltage on the rating plate which should correspond to the voltage at your home.
- Connect the power and switch on the motors and lighting system to check the operation.
- Check the following accessories before installation:
6" Exhaust duct adapter x 1 pc, Detachable oil cup x 2 pcs, Oil dish x 2 pcs, Light bulb x 1 pc, Instruction manual x 1 pc, Hardware package x 1 set (M6 x 1 1/2 wood screw x 4 pcs + washer x 4 pcs + 3/16 x 1 washer head screw x 4 pcs + M4 x 8 screw x 2 pcs)

1.Location

- Air turbulence coming from the window(s) or door(s) may affect the effectiveness of the range hood. It helps by closing certain of them **before using the hood or during using the hood.**
- The smoke rises to 25 cm to hit the suction range of the range hood.

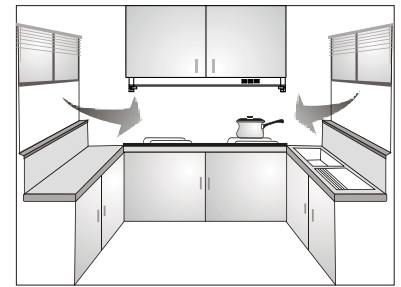

(FIG.1)

2.Position

- The installation height is measured vertically from center of fan grille of hood to the top of the stove. The minimum installation height should not be less than 65 cm and therecommended height is 70±5 cm.

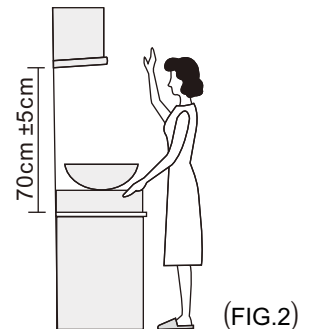

(FIG.2)

3.Keep the range hood horizontally

- Avoid left-right or front-dropped inclination.
- Avoid the oil leaking from oil cup.

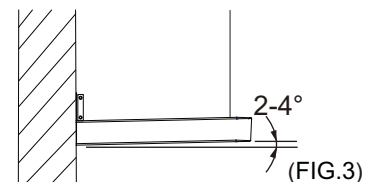

(FIG.3)

4.Exhaust duct

- 6" diameter exhaust duct is recommended to maximize performance and cutting the no. of bends also helps.
- Before installing the hood, please apply fast drying glue to the collar and securely attach it to the top of the cooker hood's vent lid. Install the cooker hood and exhaust duct to the plastic collar and seal with fast drying glue.

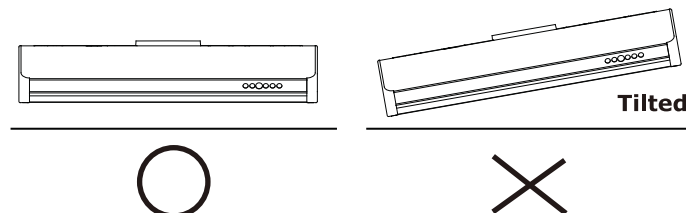

5. To ensure drainage performance, the hood shall be tilted upward 2 -4 mm as shown in figure.
Note: A rubber cushion (at rear housing) MUST NOT be removed to avoid possible unstable/ noisy and oil spillage.

Mounting method

Cabinet cut-out size

Built-in hood is designed for installing under a kitchen cabinet. Below cut-out size is for side mounting.

* Installation dimension of the hood to align with the housing of kitchen cabinet.

* Installation dimension of the hood to align with the door of the kitchen cabinet.

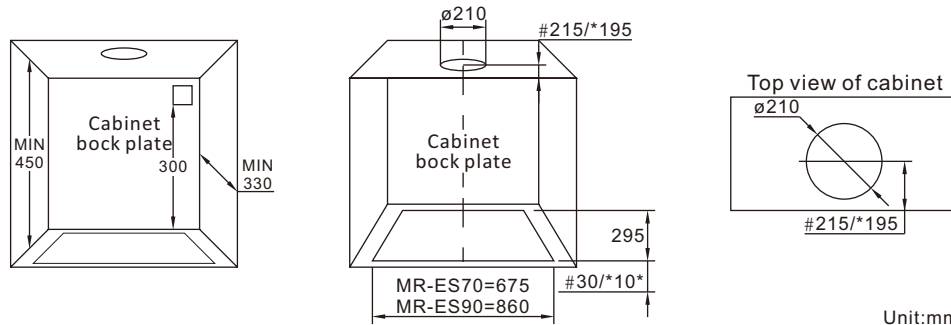

Unit:mm

I. Side mounting

1. Dismount the bottom panel : loosen safety screw and rotate the easy swivel knobs at both ends anti-clockwise to " - " position followed by pulling the bottom panel downward.
2. Anti-clockwise to detach the grease residual pan.
3. Fix the hood in the cabinet.
4. Use four 6#1 1/2" wood screws with four 5x12x1T washers to secure the two sides of the hood to the cabinet. Tighten each screw to secure the hood to the cabinet.
5. Clockwise to install the grease residual pan. To put back the bottom panel in situ and then rotate the two easy swivel knobs at both ends clockwise to " I " position to lock it.

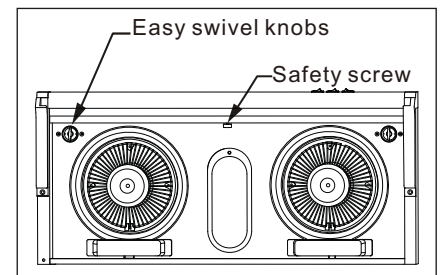

II. Top mounting

1. Follow the right diagram to drill/cut out the required openings for ducting and mounting. Four Ø8 holes are for top mounting. Two Ø15 holes are for removing the cover of electrical assembly above the hood (this is for maintenance or repair purpose).

One Ø210 is for installing collar.

Installation dimension of the hood to align with the housing of kitchen cabinet

* Installation dimension of the hood to align with the door of the kitchen cabinet

2. Use four 3/16" x 1" screws to secure the hood to the cabinet. Tighten each screw to secure the hood to the cabinet.

Note: Please refer to below dimension diagram to measure and adjust the height of cabinet (see right figure).

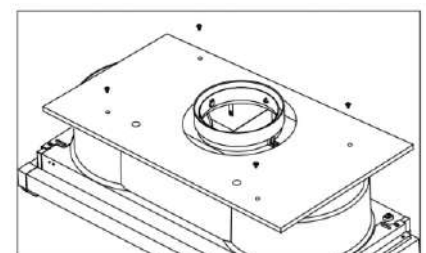
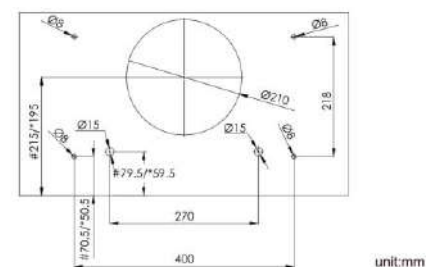

Keyboard operation

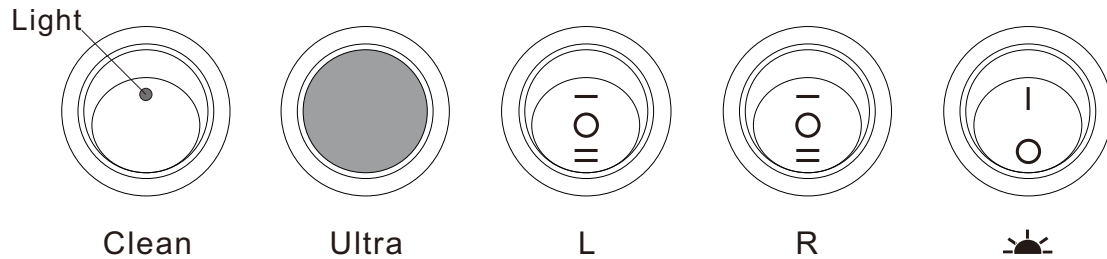

(1) Heating Cleaning Button

- a. When heating cleaning is progress, press this button once more to cancel the operation if desired.
- b. The surface of hood might get slightly hot during operation.
- c. When the fans off :
Press the button, the heating cleaning cycle is set for 15 minutes with backlit.
After 15 minutes, the fans and backlit will turn off.
- d. When the fans on :
Press the button, the fans pause to work and heating cleaning cycle is set for 15 minutes with backlit. After 15 minutes, the backlit will turn off and the fans start to work with the same speed.

(2) Ultra Speed Adjust Button

Press this button with backlit, the right and left fan to activate high speed accompanied ; press this button to cancel at once.

(3) Left Fan Speed Adjust Button

"—" is low speed, "=" is high speed, "O" is off.

(4) Right Fan Speed Adjust Button

"—" is low speed, "=" is high speed, "O" is off.

(5) Light Button

"I" is light on, another side is light off.

Maintenance & Cleaning

1. Disconnect the power supply before cleaning.
2. Internal and external cleaning of the hood enhances longevity.
3. Fan protection grille can be disassembled for cleaning by unscrewing and it must be screwed back afterwards.
4. Oil dish on the grille can also be detached for cleaning by turning the oil dish anti-clockwise.
5. The oil cup in the centre of the hood for holding grease can be detached and cleaned regularly.
6. As a good habit, turn on the hood before using the stove for better ventilation.
7. The corner easy rotary knobs lock the bottom panel, turn them anti-clockwise to “--” position to disassemble it for jobs like cleaning / repairing / changing of lamp bulb.
After the job is done, assemble the bottom panel back in its place and turn the easy rotary knobs clockwise to “|” position to lock it.
8. Disconnect the power supply before installing / changing of light bulb. Please refer to (7) above to disassemble / assemble the bottom panel followed by taking off/ putting on the lamp bulb.

NOTE: Use ONLY $\leq 14W$ energy saving lamp with certified international safety logo.

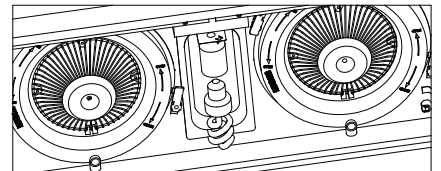
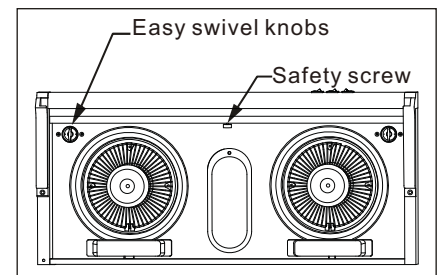
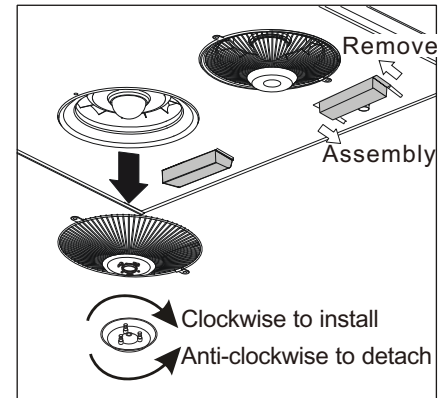
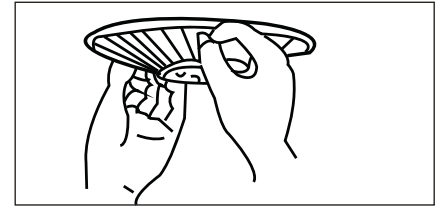



抽油煙機免費保用條款

1. 本產品只供家居使用。如產品被使用於非家居環境，包括商業，工業，或其他用途，本公司均不提供免費保用。
2. 在家居環境正常使用下，自購買日起保用三（3）年。免費保用只在香港特別行政區範圍內有效。
3. 不論是否在免費保用期內，本公司不提供長洲、坪洲、南丫島及大嶼山（東涌及愉景灣除外）等離島地區，以及需持禁區紙進入之地區的上門維修服務。此外，東涌、愉景灣及馬灣的用戶需繳付維修人員交通費用，方可安排上門服務，具體金額將另行報價。
4. 任何電子組件及零件，均只保用三（3）年。
5. 本公司只就產品之效能做保用。所有消費性零件部件包括燈泡，防煙擋，油杯，外殼，扇葉保護網，燈片及其他未述及的消費性零件部件，均不保用。
6. 在免費保用期內，在正常使用的情況下，產品發生故障，本公司免費上門維修及供應零件。
7. 如果發生摩打自身燒壞，用戶可要求本公司安排更換。本公司將免費提供摩打。但如果免費保用期已滿，則用戶需支付服務人工費用。這項服務僅限於產品仍通常在家居環境中正常使用的情況下才提供。
8. 因非正常使用引起之故障，包括：使用不當，安裝不當，人為損壞，外力破壞或天災地變等，均不在免費保用範圍之內。本公司有全權判定故障是否屬於非正常使用，顧客不得異議。
9. 用戶行使免費保用時，必須先當面向本公司維修員出示購買有關產品之發票，方可享用免費保用。

Terms of Warranty for Range Hoods

1. This product is for home use only. If the product is used in non-domestic environments, including commercial, industrial, or other purposes, the Company does not provide free warranty.
2. Under normal use in the home environment, enjoy free warranty for three (3) years from the date of purchase. The free warranty is valid only within the Hong Kong Special Administrative Region.
3. Regardless of whether the product is within the free warranty period, our company does not provide on-site repair services for Outlying Islands including Cheung Chau, Peng Chau, Lamma Island, and Lantau Island (except Tung Chung and Discovery Bay), as well as areas requiring restricted area permits. Additionally, customers in Tung Chung, Discovery Bay, and Ma Wan will be required to pay technician transportation fees for on-site service, with specific charges to be quoted separately.
4. Only three (3) year free warranty for electronic components and parts.
5. The Company only guarantees the effectiveness of the product. All consumable parts including bulbs, smoke guards, oil cups, housings, fan protection screens, light panels and other consumable parts are not covered.
6. Within the free warranty period, in the case of normal use, the company shall provide free home repair services and supply parts while product failure occurs.
7. If motor self burnout occurs, customer can ask the company to arrange for replacement. The company will provide the motor free of charge, but service fee will be charged against the customer if free warranty is expired. This service is provided only if the product is usually in normal use in home environment.
8. Failure due to abnormal use, including: improper use, improper installation, man-made damage, external damage or natural disasters, etc., are not within the scope of free warranty. The Company has the sole discretion to determine whether the failure is due to abnormal use, the customer shall not object.
9. While exercising free warranty, customer must first provide the original copy of purchase invoice to the company's maintenance personnel upon their arrival to the domestic address.

此非保用證。請登入本公司網址登記免費保用

This is not a Warranty Card. Please log in our website for warranty registration

www.dongwoo-hk.com

維修部電話 Service Phone No. 23936060



東宇實業有限公司
Dong Woo Industrial Co. Ltd.

香港沙田大圍成運道21-23號 群力工業大廈2樓1室
Rm 1,2/F, Kinglet Industrial Building, 21-23 Shing Wan Road, Taiwai, Shatin, Hong Kong
TEL:2604-9777 FAX:2607-3165